

Solar GEL Battery

6FM150F/12VoIt 150Ah

Solar GEL Series Batteries are specially designed for telecom use with 12+ years design life in float service. By adopting advantage AGM-GEL technology and centralised venting system, the battery can be installed in any position while maintaining high reliability.

General Features

- Heavy Duty Grid
- Mechanized assembly
- Non-spillable construction
- High Reliability and Stability
- Sealed and Maintenance-free
- Long Life and low self-discharge design

Construction

- Negative.....Lead
- Terminal.....Copper
- Positive.....Lead dioxide
- Electrolyte.....Sulfuric acid
- Separator.....Fiber glass
- Safety Valve.....EPDR
- Container.....ABS(UL94-HB) / (UL94-V0)



Specification

Battery Model	Nominal Voltage	12V			
	Rated capacity (10Hour rate)	150Ah			
	Cells Per battery	6			
Dimension	Length	Width	Height	Total Height	
	551mm	110mm	289mm	289mm	
Approx Weight	43.5Kg				
Internal Resistance	Full charged at 25°C(77°F): Approx 3.8mΩ				
Max.discharge current	1200A(5s)				
Floating design life @ 25°C (77°F)	12 years				
Capacity @ 25°C (77°F)	10Hour rate(15A/10.8V)	5Hour rate(24.2A/10.5V)	3Hour rate(30A/10.5V)	1Hour rate(61.8A/9.60V)	
	150Ah	121Ah	90Ah	61.8Ah	
Capacity affected by Temp(10 HR)	40°C (104°F)	25°C (77°F)	0°C (32°F)	-15°C(5°F)	
	102%	100%	85%	65%	
Self Discharge @ 25°C (77°F)	After 3 months storage	After 6 months storage	After 12 months storage		
	93%	84%	65%		
Charge method @ 25°C (77°F)	Cycle Use	14.5-14.9V (Initial charging current less than 45.0A)			
	Float Use	13.6-13.8V			

Outer dimension (mm)

Terminal Type (mm)

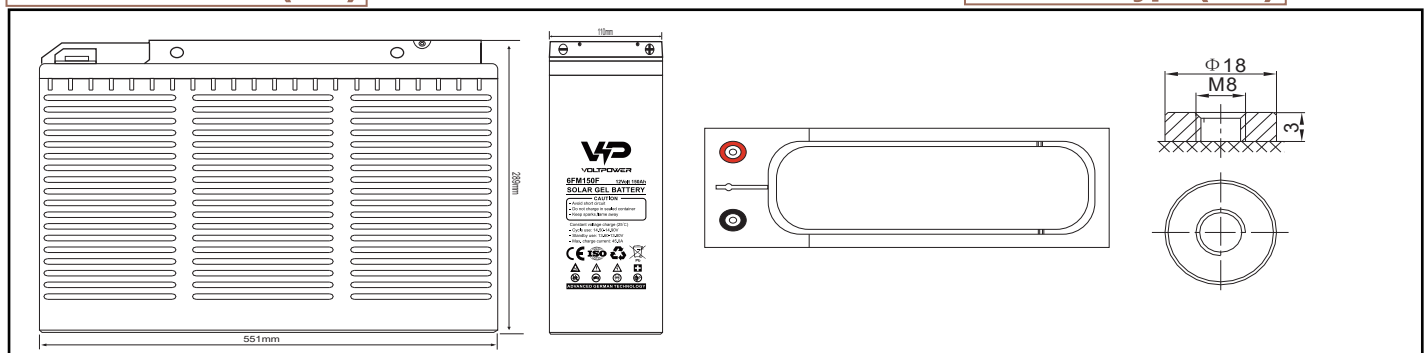

Constant Current(Amp) and Constant Power(Watt) Discharge Table at 25°C (77°F)

F.V / TIME		5min	10min	15min	30min	1h	2h	3h	4h	5h	8h	10h	20h
9.60V	A	540.00	330.00	262.50	172.50	90.00	52.50	39.00	31.50	26.31	17.37	16.50	8.55
	W	5724.00	3504.60	2808.75	1863.00	981.00	572.25	429.00	346.50	289.44	192.86	183.15	96.19
10.20V	A	495.00	331.25	241.25	163.75	93.00	50.37	38.25	30.00	25.81	17.10	15.75	8.40
	W	5395.50	3676.87	2689.94	1842.19	1046.25	569.24	432.23	340.50	292.97	194.09	178.76	95.34
10.50V	A	459.06	316.50	225.00	158.75	90.00	49.38	37.50	28.50	25.50	16.88	15.45	8.30
	W	5049.69	3560.63	2542.50	1809.74	1026.00	565.34	429.38	327.75	293.25	194.06	177.68	95.39
10.80V	A	418.00	302.50	210.00	151.50	87.00	48.12	36.75	28.00	24.38	16.44	15.00	8.19
	W	4598.00	3448.50	2404.50	1749.83	1004.85	555.84	426.30	326.20	283.97	191.50	174.75	95.41
11.10V	A	361.50	285.00	195.00	141.00	82.50	46.88	35.25	27.50	23.31	16.00	14.63	8.10
	W	4084.95	3291.75	2262.00	1649.70	965.25	548.44	414.19	324.50	275.09	188.80	172.58	95.58

Note: The above datas are average values. (Edition 2017-11)

Discharge characteristic Curve

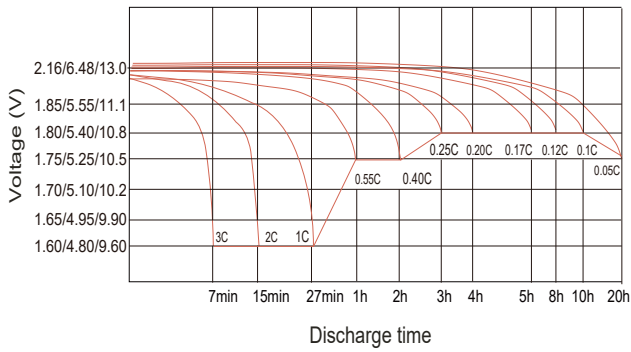

Cycle service life in relation to depth of discharge

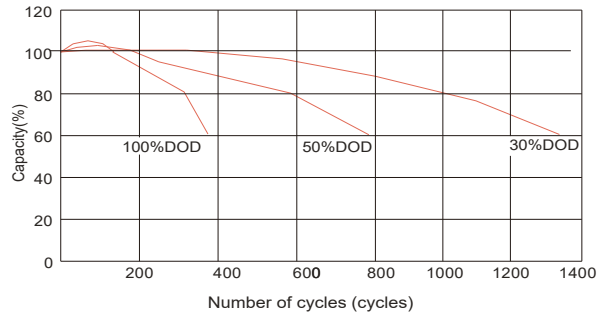

Relationship between charging voltage and temperature

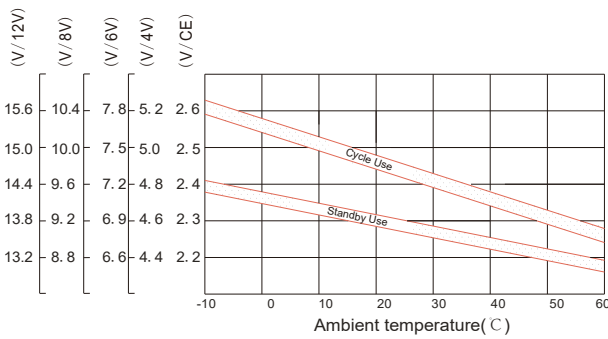

Constant voltage charging characteristic (0.25CA at 25°C)

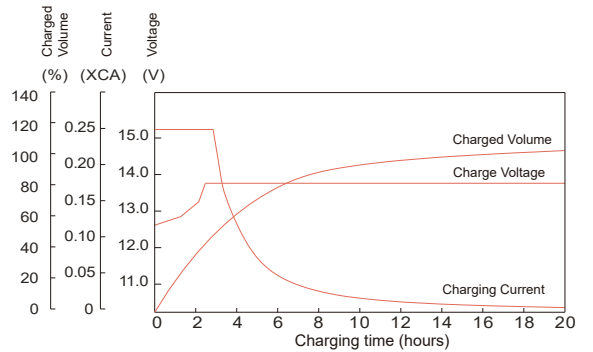

Temperature effects on float life

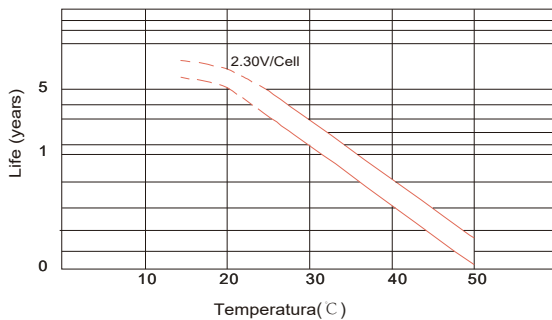

Self-discharge characteristic

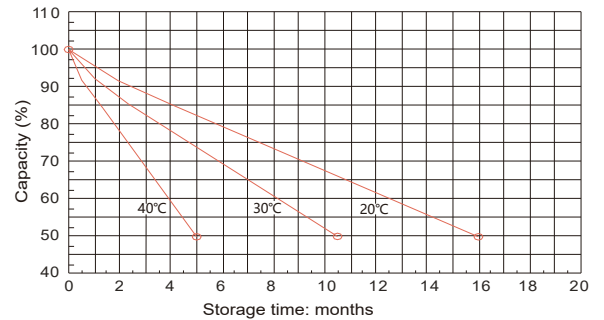

Life characteristics of standby use

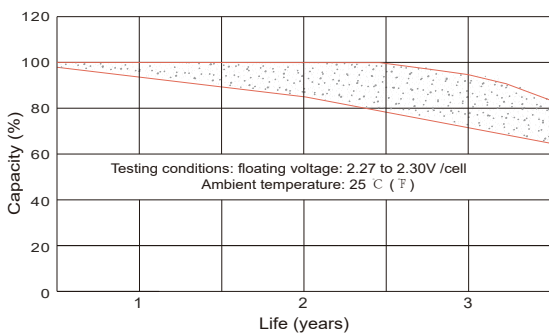

Charge characteristic Curve for standby use

